

842/c

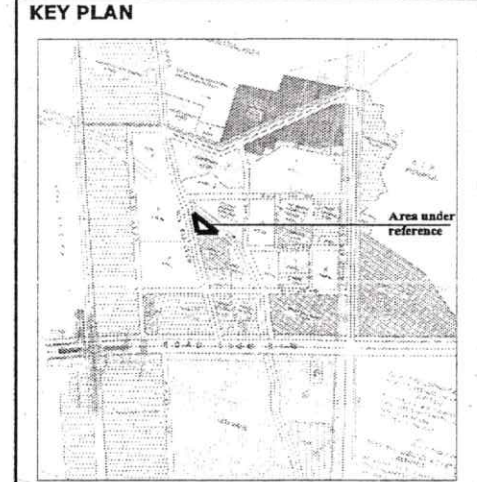

Layout Plan of IFC, Narela

TOTAL AREA OF PLOT 1.05 Ha. (10,561 sqm.)

i) Utility (Area Under Plot for installation of online booster)	200 sqm.
ii) Recreational (Park)	10,361 sqm.

5 (i)  
 370 : 63 : 2019

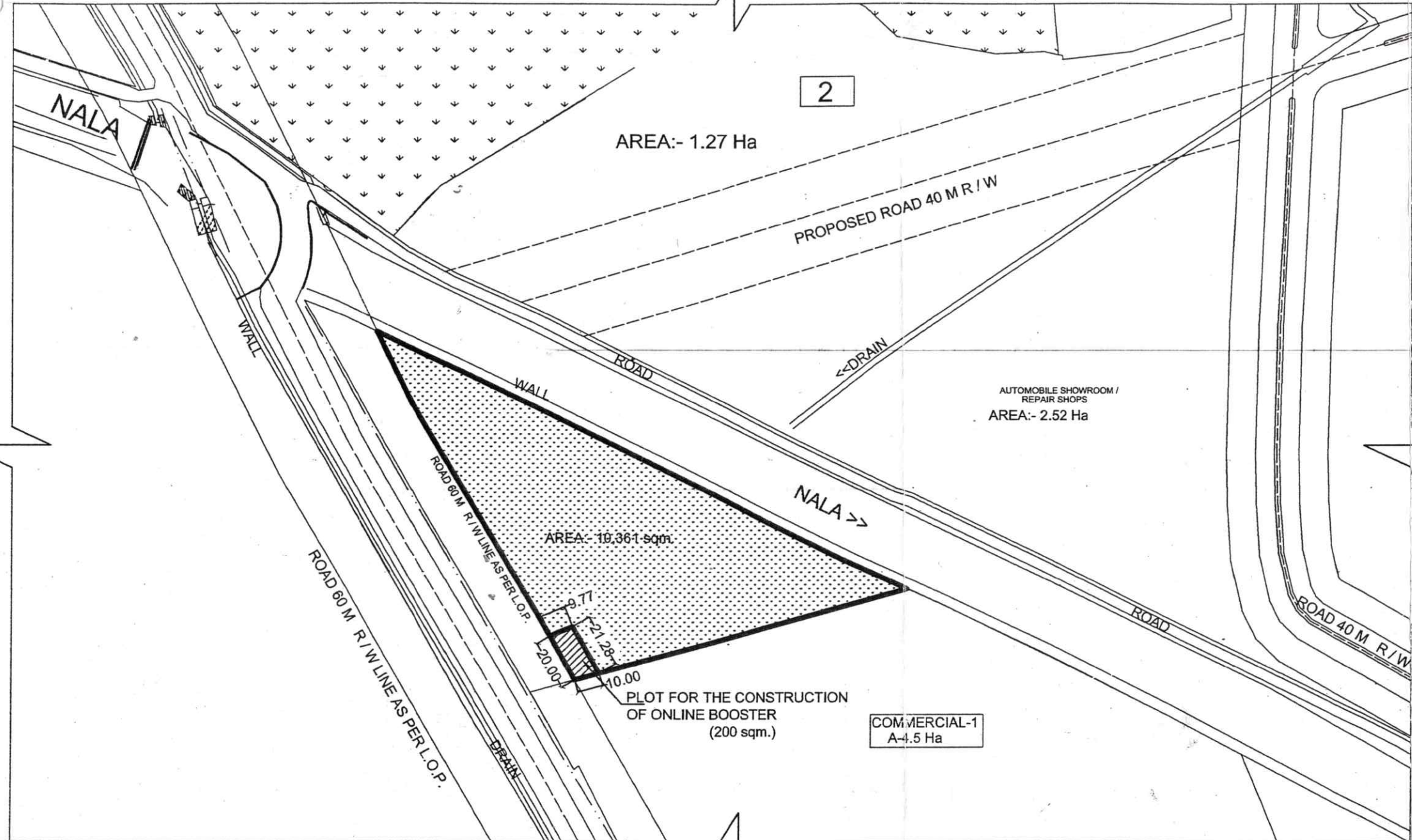

THE PROPOSAL WAS PRESENTED BY DIR (PLG.) NP.  
 AFTER DETAILED DELIBERATION, THE PROPOSAL  
 AS REFLECTED IN THE AGENDA WAS APPROVED.

DELHI DEVELOPMENT AUTHORITY  
**CERTIFIED**  
 Approved in 370<sup>th</sup> Screening  
 Committee Meeting Dt. 17.06.2019  
 Vide Item No. 63:2019  
 Sign. *[Signature]*  
 Name: *[Name]*

DELHI DEVELOPMENT AUTHORITY  
 HUPWA-CO-ORDINATION UNIT  
**VERIFIED**  
 This proposal was considered in the  
 370<sup>th</sup> Screening Committee  
 Meeting held on 17.6.19  
 Vide item No. 63:2019  
*[Signature]*  
 Dy. Director (Arch.) Co-ordn

एच० के० भारती  
 निदेशक (योजना) नरेला परियोजना  
 दिल्ली विकास प्राधिकरण  
 11वीं मंजिल, विकास मीनार  
 नई दिल्ली-110002

Legend  
 Plot for the construction of online booster  
 Park

NOTE:  
 1. Prepared on the basis of TSS received from Engineering Department, ND-9, DDA vide letter dated 0507.2019.  
 2. All dimensions are in meter.

TITLE:  
 Part Layout Plan for providing 200 sqm. plot for installation of online booster pump at IFC, Narela.

PLG. ASST.	ASST. DIR.	ASST. DIR.	VS/Narela/P1/
Dy. DIRECTOR (PLG.) NARELA	<i>[Signature]</i>	<i>[Signature]</i>	NORTH